



SERVICE BULLETIN

POWER PLANT - NACELLE - EXHAUST - STAINLESS STEEL GUIDE PADS, NO. 1 OPEN LATCH INDICATOR, THRUST REVERSER - ADDITION OF - CATEGORY CODE 8 - MOD.NAC-71-0137

NOTE: This Service Bulletin is issued for part number progression history only. It is not intended to be incorporated or kit parts ordered from the manufacturer. The intent of this modification is accomplished by the incorporation of Service Bulletin V2500-NAC-78-0092.

1. Planning Information

A. Effectivity

- (1) Airplane: Airbus A320
- (2) Nacelle: V2500-A1 thrust reverser cum units (c/u) prior to 215.

B. Reason

(1) Condition

The No. 1 open latch indicator has excessive lateral movement and can jam.

(2) Background

Present open latch indicator installation can give false open indication.

(3) Objective

Install stainless steel guide pads on the thrust reverser to provide a smooth guide path for the indicator and reduce lateral movement to prevent jams and false open indications.

(4) Substantiation

Not applicable.

(5) Impact of the Bulletin on Workshop Procedures:

Removal/Installation	Affected
Disassembly/Assembly	Not Affected
Cleaning	Not Affected
Inspection/Repair	Not Affected
Repair	Not Affected
Testing	Not Affected

(6) Supplemental Information

V2500-NAC-71-0137



SERVICE BULLETIN

None.

C. Description

The change introduced by this Bulletin is as follows:

Stainless steel guide pads for the No. 1 latch open indicator are installed on the thrust reverser halves.

D. Approval

The part number changes and/or part modifications described in Paragraphs 2 and 3 of this Service Bulletin have been shown to comply with the applicable Federal Aviation Regulations and are FAA approved for the equipment model(s) listed.

E. Compliance

Category 8

Accomplish based upon experience with the prior configuration.

F. Manpower

Estimated manhours to incorporate the full intent of this bulletin:

VENUE	ESTIMATED MANHOURS
(1) In Service	N/A
(2) In Shop	
(a) To Rework	1.0 M/Hrs.
Total	1.0 M/Hrs

G. Material Cost and Availability

Modification kit not required. Parts are supplied as single line items (Refer to Section 3, Material Information).

H. Tooling Cost and Availability

None required.

I. Weight and Balance

(1) Weight change Negligible

(2) Moment arm No effect

V2500-NAC-71-0137



(3) Datum Engine Front Mount Centerline (Powerplant Station PPS 100.00)

J. Electrical Load Data

Not affected.

K. Reference

(1) Internal Reference No.

JG/LL 90VN030B

(2) Other References

A320/A321 Aircraft Maintenance Manual 78-32-00

V2500 Standard Practices/Processes Manual 70-09-00
(SPP-V2500-1IA)

L. Other Publications Affected

A320/V2500-A1 Engine Illustrated Parts Catalog 71-00-23
(S-V2500-1IA)

A320/V2500A1 Power Plant Illustrated Parts 71-00-23
Catalog (PIP-V2500-1IA)

A320/V2500A1 Power Plant Build-up Manual 71-00-02
(PPB-V2500-1IA)



2. Accomplishment Instructions

A. Pre-requisite Instructions

None

B. Rework or Modification Instructions

(1) Install the Thrust Reverser Guide Pads

- (a) Hold the 740-0136-41 pad and 740-0136-45 shim together. Make sure the shim is against the flat (not beveled) side of the pad. Backdrill the two 0.368-0.390 inch (9.35-9.91 mm) and two 0.156-0.163 inch (3.96-4.14 mm) holes through the shims. Refer to Figure 2.
- (b) Hold the 740-0136-39 pad and 740-0136-43 shim together. Make sure the shim is against the flat (not beveled) side of the pad. Backdrill the two 0.368-0.390 inch (9.35-9.91 mm) holes and two 0.156-0.163 inch (3.96-4.14 mm) holes through the shims.
- (c) Put the shims and pads into position on the thrust reverser lower track and backdrill two 0.156-0.163 inch (3.96-4.14 mm) holes through the lower track. Refer to Figure 1.
- (d) Temporarily install the pads and shims on the thrust reverser halves with NAS7500-04 screws and MS21043-04 nuts.
- (e) Adjust the clearance between the latch open indicator and the pads when the thrust reverser and engine are installed on the aircraft. Refer to A320 Aircraft Maintenance Manual, Chapter 78-32-01 and 78-32-03.

C. Post-requisite Instructions

None.



Printed in Great Britain

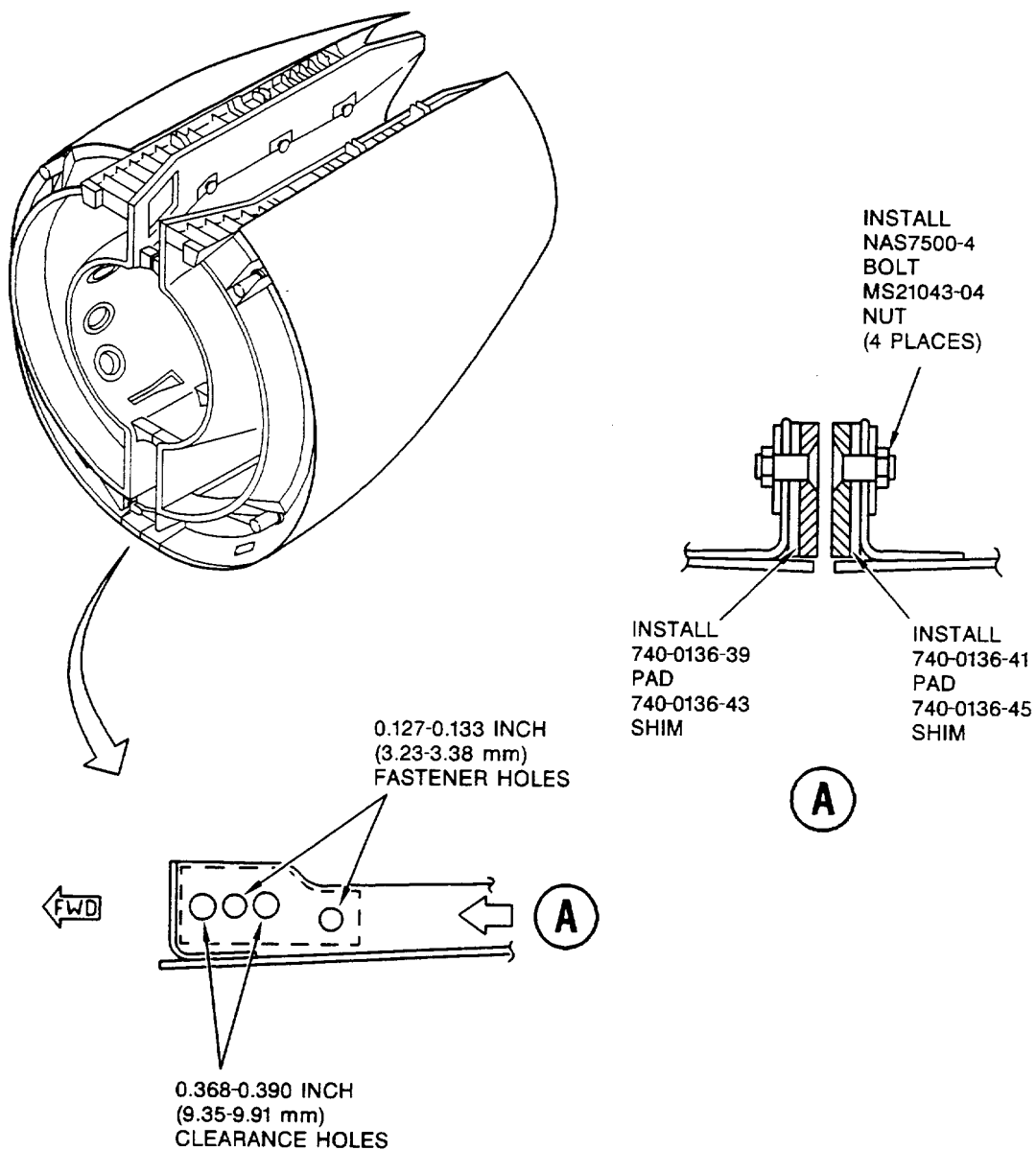

ded0000109

No. 1 Latch Open Indicator Guide Pad Installation
Fig.1

V2500-NAC-71-0137



D. Recording Instructions

- (1) A record of accomplishment is necessary. Write in the applicable records and metal stamp, vibroetch, or electroetch on the thrust reverser data plate that Service Bulletin V2500-NAC-71-0137 has been done. Refer to the IAE V2500 Standard Practices/Processes Manual, Chapter 70-09-00.

V2500-NAC-71-0137



SERVICE BULLETIN

3. Material Information

Applicability: For each V2500 Nacelle to incorporate this Bulletin

A. Kits Associated with this Bulletin:

None

B. Parts Affected by this Bulletin:

New Part No. (ATA No.)	Qty	Est'd Unit Price (\$)	Keyword	Old Part No. (IPC No.)	Instr/ Dispos
MS21043-04 (71-00-23)	4		Nut	--- (01-045)	(A) (S1)
NAS7500-04 (71-00-23)	4		Bolt	--- (01-050)	(A) (S1)
740-0136-45 (71-00-23)	1		Shim	--- (01-052)	(A) (S1)
740-0136-41 (71-00-23)	1		Pad	--- (01-054)	(A) (S1)
740-0136-43 (71-00-23)	1		Shim	--- (01-056)	(A) (S1)
740-0136-39 (71-00-23)	1		Pad	--- (01-058)	(A) (S1)

C. Instruction/Disposition Code Statements

(A) New part is available.

(S1) Parts coded S1 must be used in sets.

D. Materials Required to Incorporate this Service Bulletin:

None.

V2500-NAC-71-0137

