



SERVICE BULLETIN

POWER PLANT - NACELLE - POWERPLANT - DRAIN TUBES AND COLLECTOR PLATE ASSEMBLY -
REPLACEMENT OF - CATEGORY CODE 6 - MOD.NAC-71-0169

1. Planning InformationA. Effectivity

- (1) Aircraft: (a) Airbus A321
- (2) Nacelle: (a) V2500-A5 Nacelle Engine Buildup Unit Serial Nos prior to 25 and 26001 thru 135001.

B. Reason

(1) Condition

Several drain tubes and the collector plate assembly when installed are sometimes on the minimum clearance condition with adjacent hardware.

(2) Background

Reports have been received from production on the difficulty in installing the drain tubes and collector plate assembly to meet the minimum clearance requirements.

(3) Objective

To meet minimum clearance limits and provide drain tubes and collector plate assembly that are a better fit and so ease installation.

(4) Substantiation

Trial installation showed that the new tubes and collector plate introduced by this Service Bulletin gave the improved fit and necessary clearance.

(5) Effect of Bulletin on:

| | |
|--------------------------|--------------|
| (a) Removal/Installation | Affected |
| (b) Disassembly/Assembly | Not affected |
| (c) Cleaning | Not affected |
| (d) Inspection/Check | Not affected |
| (e) Repair | Not affected |
| (f) Testing | Not affected |

(6) Supplemental Information

The A320/V2500-A1 A320/A321/V2500-A5 Engine Manual (E-V2500-1IA) chapter 72-00-60 will be revised to include the new installation instructions.

V2500-NAC-71-0169

**C. Description**

(1) The changes introduced by this Service Bulletin are as follows:-

- (a) Two drain tubes are removed and replaced with new drain tubes.
- (b) The collector plate assembly is removed and replaced with a new collector plate assembly.
- (c) Clipping points CP0952, CP0937, CP0968 and CP1169 are revised.

D. Approval

The technical content of this Service Bulletin is covered by an Airbus Industrie Modification which is under DGAC (Direction Generale de L'Aviation Civile - France) approval.

E. Compliance

Category 6

Accomplish when the subassembly (i.e. modules, accessories, components, build groups) is disassembled sufficiently to afford access to the affected part and to all affected spare parts.

F. Manpower

Estimated manhours to incorporate the full intent of this Service Bulletin:

| VENUE | ESTIMATED MANHOURS |
|-------|--------------------|
|-------|--------------------|

| | |
|----------------|-----|
| (1) In Service | N/A |
|----------------|-----|

| | |
|-----------------|--|
| (2) At Overhaul | |
|-----------------|--|

| | |
|-------|-------|
| Total | M/Hrs |
|-------|-------|

Note: The parts affected by this Service Bulletin are accessible at overhaul.

G. Material Cost and Availability

Modification Kit not required. Parts supplied as single line items.

H. Tooling - Cost and Availability

None required.

V2500-NAC-71-0169

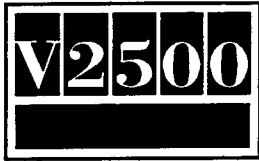

SERVICE BULLETIN

I. Weight and Balance

- (1) Weight change None
- (2) Moment arm No affect
- (3) Datum Engine Front Mount Centerline

(Powerplant Station PPS 100.00)

J. Electrical Load Data

Not affected.

K. References

- (1) Internal Reference No.

94VN009-01

94VN009-02

93VN085

- (2) Other References

A320/A321 V2500 Aircraft Maintenance Manual 71-71-42

L. Other Publications Affected

A320/A321/V2500-A5 Powerplant Illustrated Parts 71-71-42
Catalog (PIP-V2500-1IA) 71-71-48
71-73-48

A320/V2500-A5 Engine Illustrated Parts Catalog 71-71-42
(S-V2500-1IA) 71-71-48
71-73-48

A320/A321/V2500-A5 Powerplant Buildup Manual 71-00-02
(PPB-V2500-2IA)

A320/V2500-A1/A320/A321/V2500-A5 Engine Manual 72-00-60
(E-V2500-1IA)



2. Accomplishment Instructions

A. Rework Instructions

None.

B. Assembly Instructions

NOTE: Route the drain tubes so that the flow direction arrows on the tubes point towards the Drains Mast.

- (1) Install the 745-5267-501 tube as shown. Hand tighten the couplings only at this stage (Refer to Figure 1, Sht 1).
- (2) Install the 745-5688-501 tube (from the Bifurcation Panel) as shown. Hand tighten the couplings only at this stage (Refer to Figure 1, Sht 2).
- (3) Install the new 745-5682-501 Collector Plate Assembly as instructed in the V2500/A320/A321 Aircraft Maintenance Manual, Task 71-71-42-410-010.

Assemble clipping point CP0954 as shown with an AS21408 Bolt, 400WSS4 'P'Clip, 400WSS16 'P'Clip, and AS20624 Nut and an SP154D Washer (Refer to Figure 1, sheet 3).

(5) Assemble clipping point CP0953 as shown with an AS21408 Bolt, 400WSS4 'P' Clip, an AS20624 Nut and an SP154D Washer.

(6) Assemble clipping point CP0949 as shown with an AS21408 Bolt, 400WSS4 'P' Clip, an AS20624 Nut and an SP154D Washer. (Refer to Figure 1, sheet 4).

(7) Assemble clipping point CP0952 as shown with a new AS21411 Bolt, 400WSS4 'P'Clip and a new ST1698D47 Spacer.

(8) Assemble clipping point CP0968 as shown with an AS21408 Bolt, 400WSS4 'P' Clip, AS20624 Nut and an SP154D Washer. (Refer to Figure 1, sheet 5).

(9) Assemble clipping point CP1396 as shown with an AS21411 Bolt, 400WSS4 'P'Clip an 400WSS12 'P' Clip an ST1698D47 Spacer an AS20624 Nut and an SP154D Washer.

(10) Assemble clipping point CP1169 as shown with a new 4W0106 Bolt, 400WSS4 'P' Clip an 400WSS12 'P' an AS20624 Nut and an SP154D Washer. (Refer to Figure 1, sheet 6).

(11) Assemble clipping point CP0937 as shown with a new AS21415 Bolt, 400WSS4 'P' Clip a new ST1698D48 spacer an AS20624 Nut and an SP154D Washer.

V2500-NAC-71-0169

**SERVICE BULLETIN**

(12) Make sure that all tubes are free from pre-load and that a minimum clearance of 0.25 in (6 mm) is maintained between the tubes and adjacent structure/hardware.

(13) Torque the couplings at both ends of the 745-5267-501 and 745-5688-501 tubes to 110 to 125 lb in (12 to 14 Nm).

(14) Torque the bolts at clipping points CP0954, CP0953, CP0949 CP0952, CP0968, CP1396, CP1169 and CP0937 to 20 to 25 lbf in (2 to 3 Nm)

C. Recording Instructions

(1) A record of accomplishment is necessary.

V2500-NAC-71-0169

Oct.17/97

Page 5

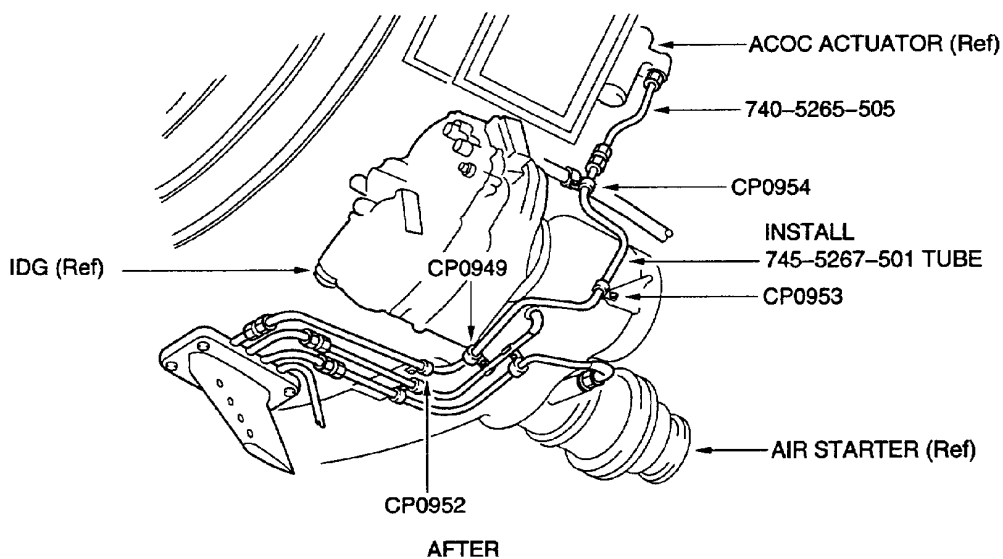
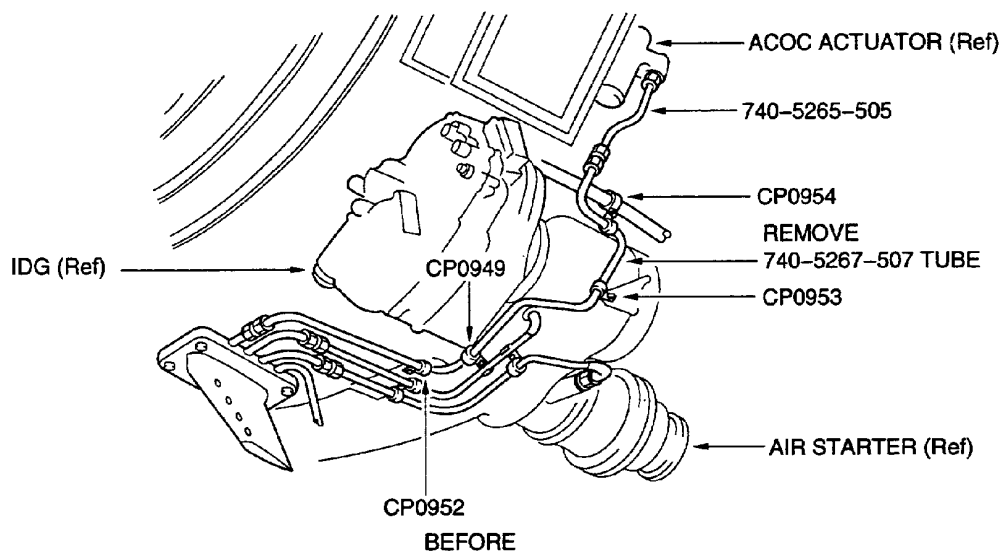
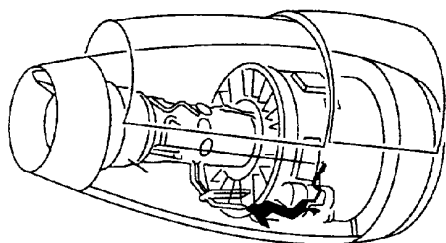

INSTALLATION OF DRAIN TUBES
Fig.1 (SHEET 1)

ded0002293

V2500-NAC-71-0169



SERVICE BULLETIN

Printed in Great Britain

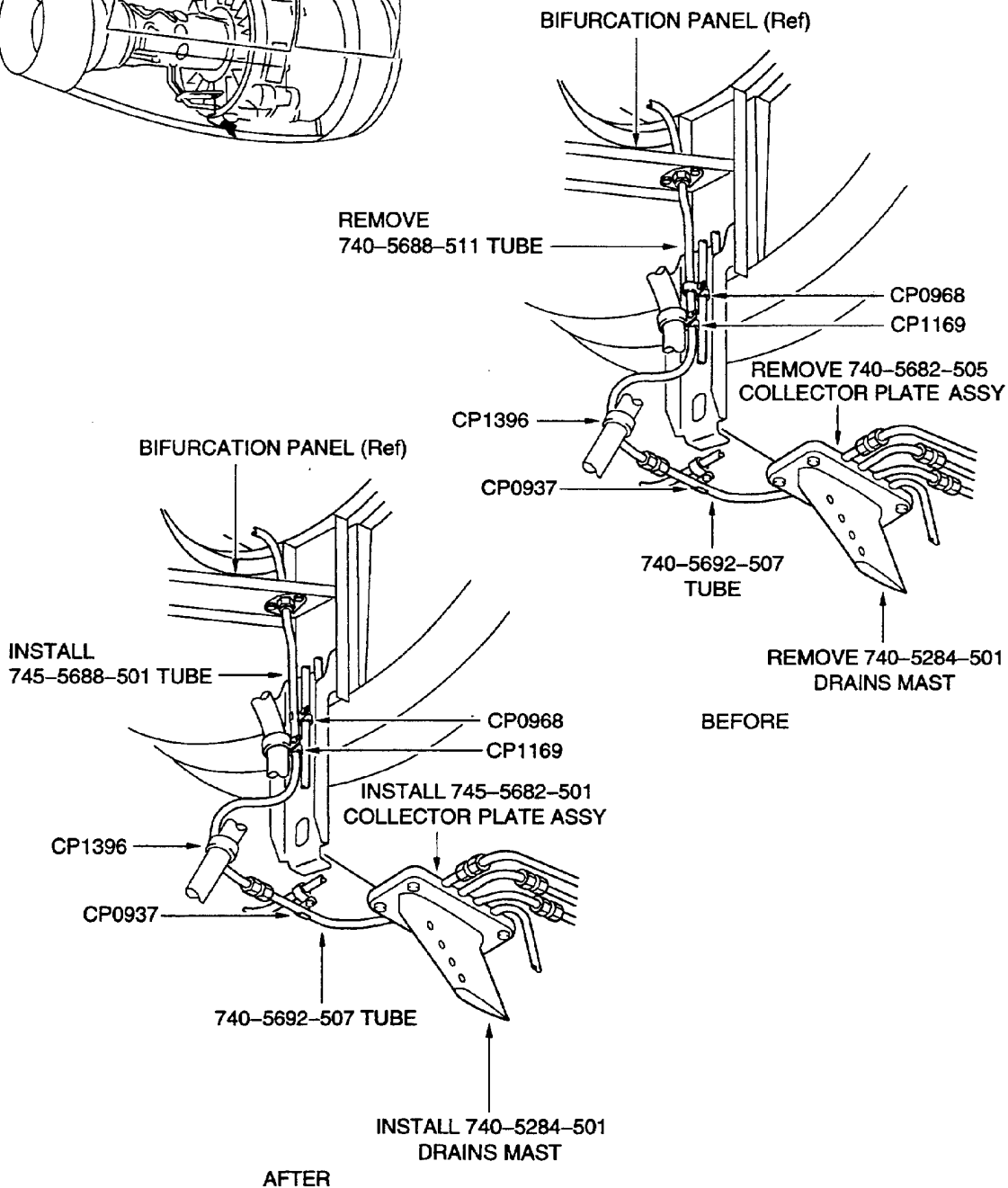
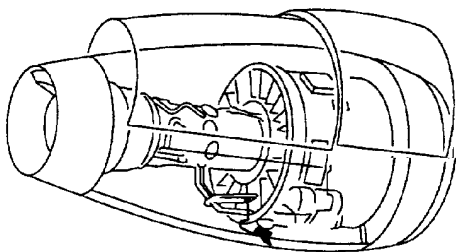
INSTALLATION OF DRAINS TUBES
Fig.1 (SHEET 2)

V2500-NAC-71-0169



SERVICE BULLETIN

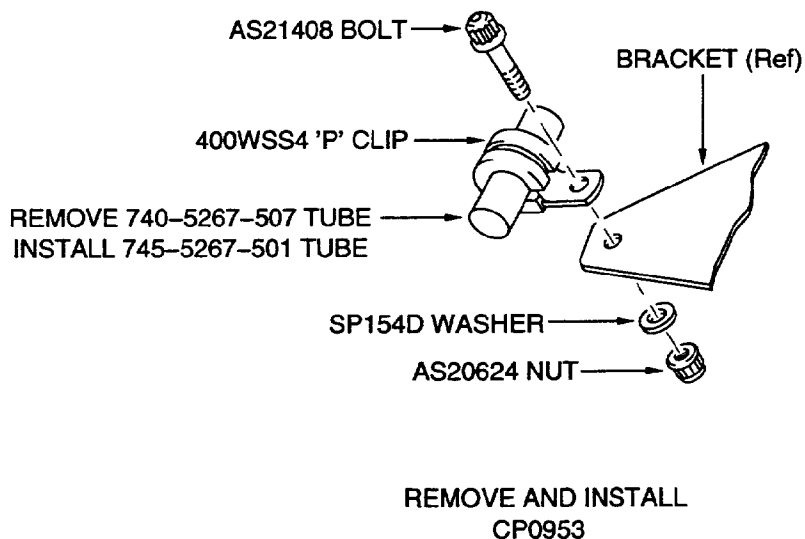
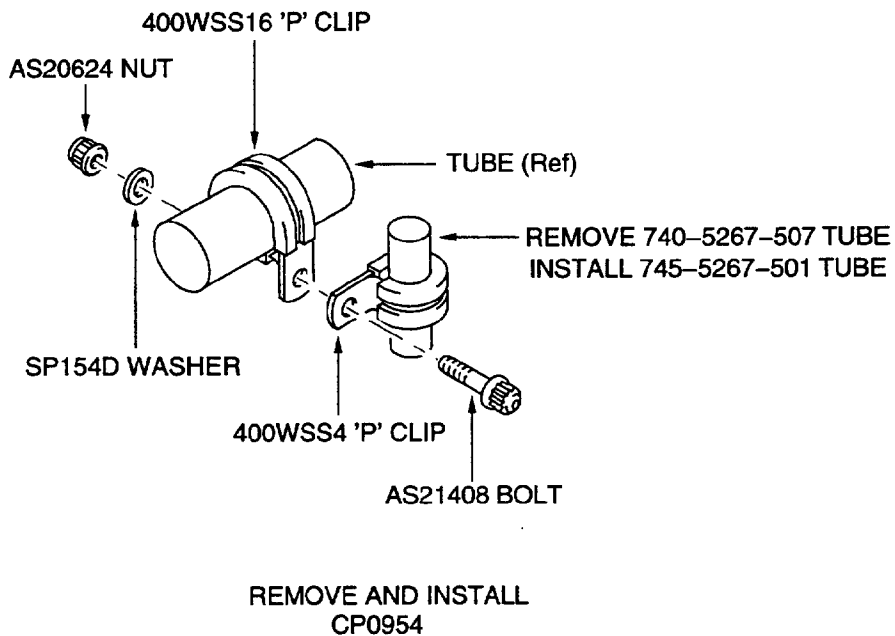

REMOVAL/INSTALLATION OF CLIPPING POINTS
Fig.1 (SHEET 3)

V2500-NAC-71-0169



SERVICE BULLETIN

Printed in Great Britain

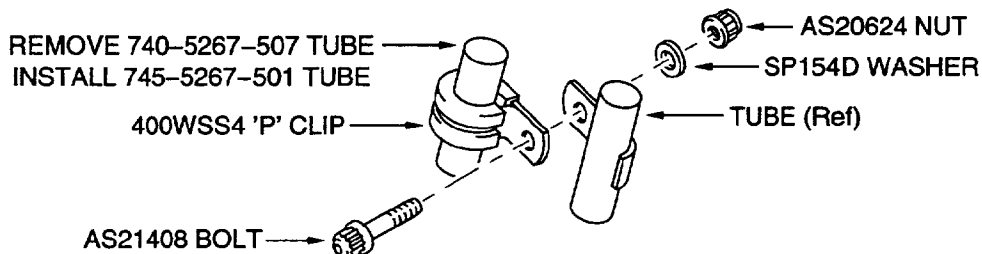

CP0949
REMOVE AND INSTALL

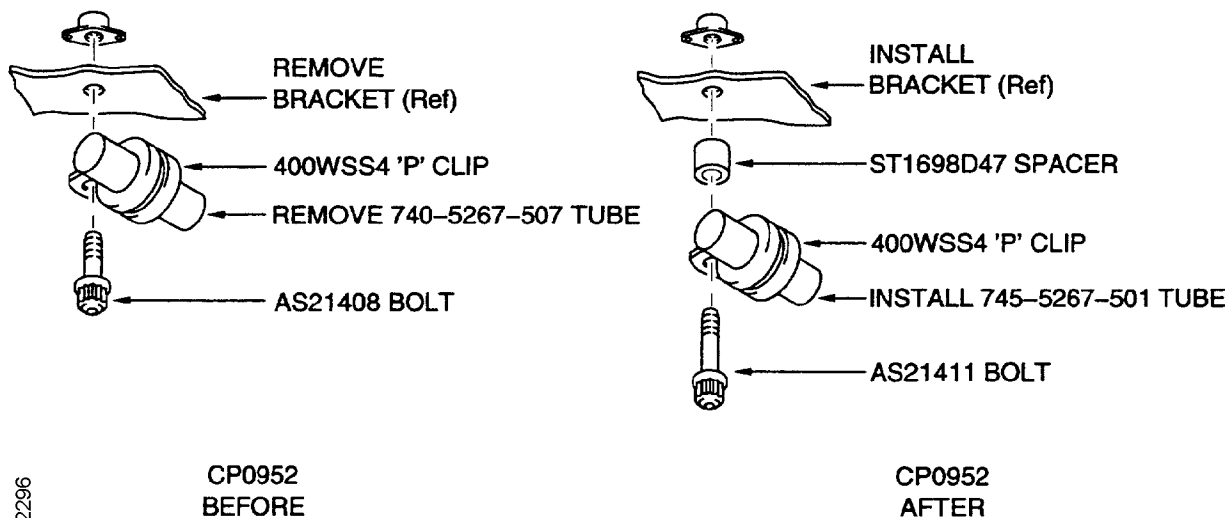

ded0002296

REMOVAL/INSTALLATION OF CLIPPING POINTS
Fig.1 (SHEET 4)

V2500-NAC-71-0169



SERVICE BULLETIN

Printed in Great Britain

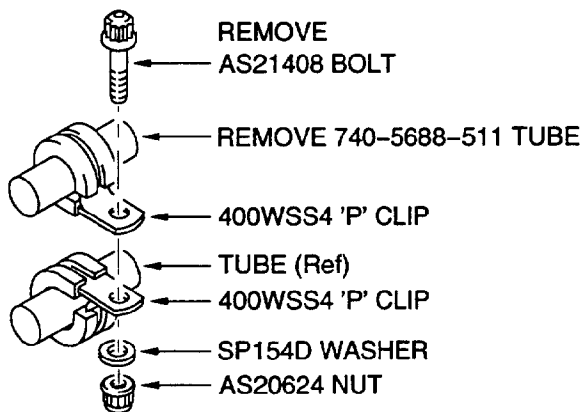

CP0968
BEFORE

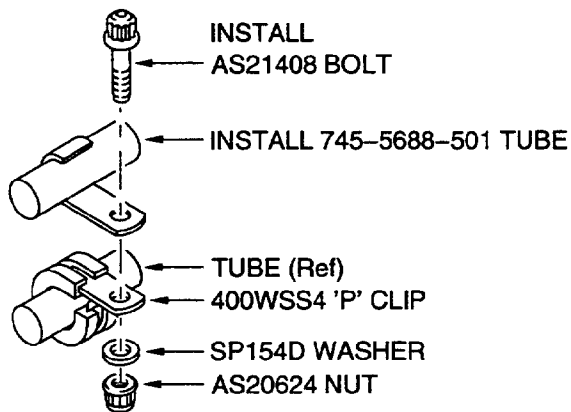

CP0968
AFTER

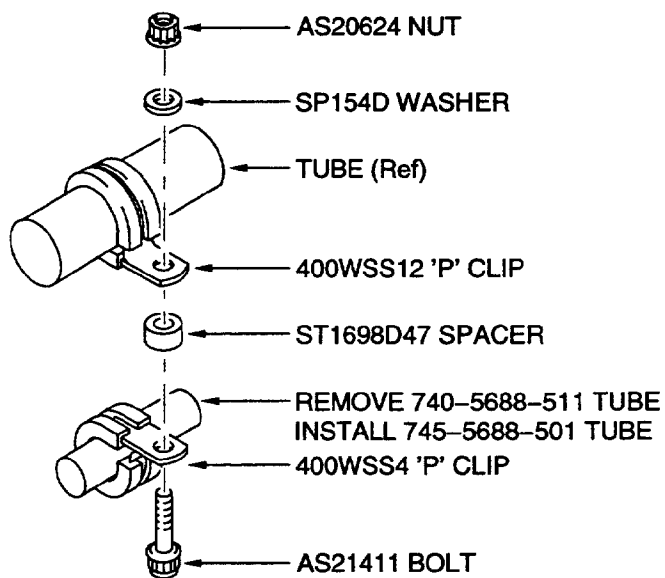

CP1396
REMOVE AND INSTALL

REMOVAL/INSTALLATION OF CLIPPING POINTS
Fig.1 (SHEET 5)

V2500-NAC-71-0169



SERVICE BULLETIN

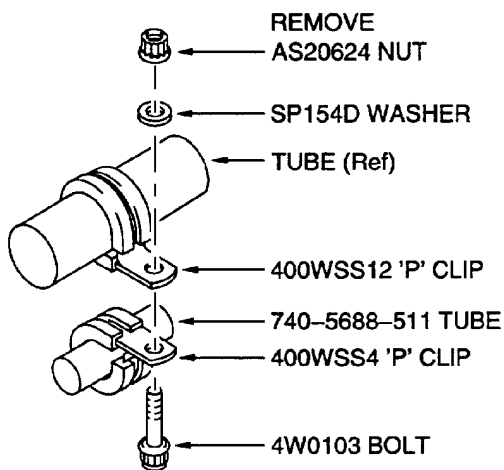

CP1169
BEFORE

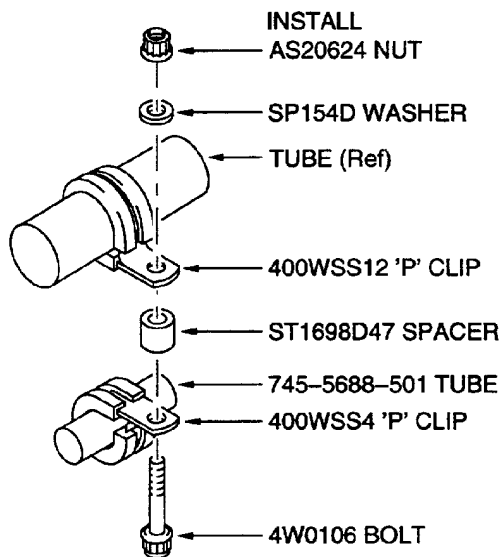

CP1169
AFTER

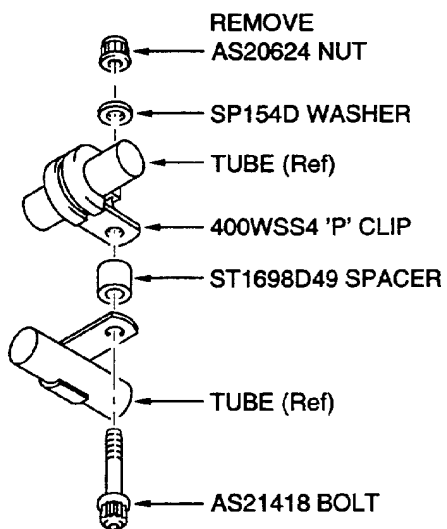

CP0937
BEFORE

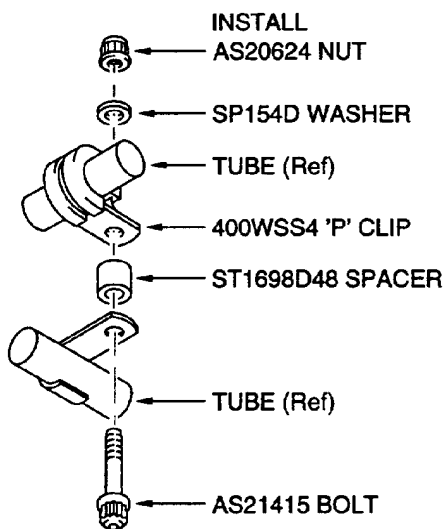

CP0937
AFTER

REMOVAL/INSTALLATION OF CLIPPING POINTS
Fig.1 (SHEET 6)

ded0002298

V2500-NAC-71-0169

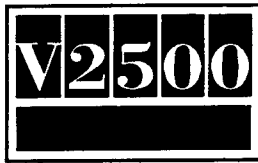

SERVICE BULLETIN

Applicability: For each V2500 Nacelle to incorporate this Bulletin.

A. Kits associated with this Bulletin

None.

B. Parts affected by this Bulletin

| NEW PART NO. (ATA No.) | QTY | EST'D UNIT PRICE (\$) | KEYWORD | OLD PART NO. (IPC No.) | INSTR/ DISPOS |
|------------------------------|-----|-----------------------------|-----------------------|------------------------------|------------------|
| 745-5682-501 (71-71-42) | 1 | | .Collector Plate Assy | 740-5682-505 (01.050) | (A)(1D) (S1) |
| 745-5267-501 (71-73-48) | 1 | | .Tube Assy, Drain | 740-5267-507 (03-500) | (A)(1D) (S1) |
| AS21411 (71-73-48) | 1 | | .Bolt, CP0952 | AS21408 (03-549) | (A)(2D) (S1) |
| ST1698D47 (71-73-48) | 1 | | .Spacer, CP0952 | --- (03-550) | (A)(2D) (S1) |
| 745-5688-501 (71-71-48) | 1 | | .Tube Assy, Drain | 740-5688-511 (03-400) | (A)(1D) (S1) |
| 4W0106 (71-71-48) | 1 | | .Bolt, CP1169 | 4W0103 (03-425) | (A)(2D) (S1) |
| ST1698D47 (71-71-48) | 1 | | .Spacer, CP1169 | --- (03-428) | (A)(2D) (S1) |
| AS21415 (71-71-48) | 1 | | .Bolt, CP0937 | AS21418 (03-705) | (A)(2D) (S1) |
| ST1698D48 (71-71-48) | 1 | | .Spacer, CP0937 | ST1698D49 (03-710) | (A)(2D) (S1) |

RQ* = Quote only basis.

C. Instructions/Dispositions Code Statements

(A) New part currently available.

(1D) Discard old part.

(2D) Old part can be used up on other applications.

(S1) New parts coded (S1) must replace old parts coded (S1) as a complete set.

NOTE: The estimated 1997 unit price shown is provided for planning purposes only and does not constitute a firm quotation. Consult the Rohr Price Catalog or contact Rohr's Spares Parts Sales Department for information concerning firm prices.

Printed in Great Britain

V2500-NAC-71-0169