



400 MAIN STREET, MAIL STOP 121-10
EAST HARTFORD, CT 06108, USA.
TELEPHONE:- 860 565 5515
FAX:- 860 565 0600

DATE: Aug. 6/08

P.O. BOX 31, DERBY
TELEGRAMS - 'ROYCAR' DERBY
TELEX - 37645
TELEPHONE:- 44 (0) 1332 242424
FAX:- 44 (0) 1332 249936

V2500-A1/A5 SERIES PROPULSION SYSTEMS SERVICE BULLETIN

Printed in Great Britain

This document transmits Revision 1 to Service Bulletin V2500-NAC-71-0227

Document History

Service Bulletin Revision Status

Initial Issue May.19/99

Service Bulletin Revision 1

Remove	Incorporate	Reason for change
All pages of the Service Bulletin.	Pages 1 to 9 of the Service Bulletin.	To revise the Concurrent Requirements, Material Information and the Rework Instructions.

V2500-NAC-71-0227
Transmittal - Page 1 of 1

CHECK THAT ALL PREVIOUS TRANSMITTALS HAVE BEEN INCORPORATED
If any have not been received please advise Customer Data Services, Rolls-Royce plc, Derby, England
© Rolls-Royce plc (date as above) Printed in Great Britain

NACELLE – POWERPLANT – FAN COWL DOOR LATCH HANDLES – APPLICATION OF FLUORESCENT PAINT

Printed in Great Britain

1. Planning Information**A. Effectivity****(1) Airplane:**

Airbus A319, A320, A321.

(2) Nacelle:

(a) ALL V2500-A1 Fan Cowl Doors.

(b) V2522-A5 Fan Cowl Doors prior to Serial Number 1613001.

(c) V2524-A5 Fan Cowl Doors prior to Serial Number 1613001.

(d) V2527-A5 Fan Cowl Doors prior to Serial Number 1613001.

(e) V2527E-A5 Fan Cowl Doors prior to Serial Number 1613001.

(f) V2530-A5 Fan Cowl Doors prior to Serial Number 1613001.

(g) V2533-A5 Fan Cowl Doors prior to Serial Number 1613001.

B. Concurrent Requirements**R** Simultaneous incorporation of Service Bulletin V2500-NAC-71-0256 is mandatory.**C. Reason****(1) Condition**

Several Operators have reported instances of Fan Cowl Doors Loss due to doors not being properly closed and latched prior to flight.

(2) Background

Not applicable.

(3) Objective

The intent of this Service Bulletin is to make the door latch handles more visible and to ensure latches are closed before take-off.

(4) Substantiation

None.

(5) Effect of Bulletin on:

(a) Removal/Installation

Not affected.

(b) Disassembly/Assembly

Not affected.

(c) Cleaning

Not affected.

(d) Inspection/Check

Not affected.

(e) Repair

Not affected.

(f) Testing

Not affected.

(6) Supplemental Information

None.

D. Description

The change introduced by this Service Bulletin is the addition of red/orange fluorescent paint to the four Fan Cowl Door Latch handles on the right hand door on both engines.

E. Compliance

Category Code 4

Accomplish at the first visit of the Nacelle or Nacelle Component to a maintenance base capable of compliance with the accomplishment instructions regardless of the planned maintenance action for the Nacelle or Nacelle Component.

F. Approval

R The technical content of this Service Bulletin has been approved under the authority of the EASA Design Organization Approval Number EASA.21J.031.

R The authorising IAE documents are EC 96VN208 and 01VN758.

G. Manpower

Estimated man-hours to incorporate the intent of this Service Bulletin on each engine:

(1) In Service

To gain access - 0.25 M/Hr.

To embody - 5.50 M/Hr.

Total - 5.75 M/Hr.

(2) At Overhaul

Not applicable.

NOTE: Man-hours provided for planning purposes only.

H. Material Cost and Availability

Modification kit not required.

I. Tooling - Cost and Availability

None required.

J. Weight and Balance**(1) Weight Change**

None.

(2) Moment arm

No effect.

(3) Datum

Engine Front Mount Centreline (Powerplant Station PPS 100.00).

K. Electrical Load Data

Not affected.

L. References

(1) Airbus A319/A320/A321 Aircraft Maintenance Manual (V2500-1IA), Chapter/Sections 71-13-00.

(2) IAE Overhaul Processes and Consumable Index (PCI-V2500-1IA).

(3) IAE Standard Practices/Procedures Manual (SPP-V2500-1IA), Chapter/Sections 70-09-00.

R (4) Engineering Change Numbers 96VN208 and 01VN758.

(5) Airbus Aircraft Modifications 21948 and 24259.

M. Other Publications Affected

(1) IAE V2500 Engine Illustrated Parts Catalogs (S-V2500-1IA, S-V2500-2IA, S-V2500-2IB, S-V2500-5IA, S-V2500-5IB, S-V2500-6IA, S-V2500-6IB, S-V2500-7IA, S-V2500-7IB), Chapter 71-13-13, will be revised to include the new part.

Printed in Great Britain

2. Material Information

A. Kit associated with this Service Bulletin

None.

B. Parts affected by this Service Bulletin

NOTE: Applicability: V2500-A1/A5 Nacelle to incorporate this Service Bulletin.

FIG ITEM NO.	NEW PART NO.	QTY	PART TITLE	MAT	OLD PART NO.	INSTR DISP
71-13-13						
R 02-010	H3187-11	4	..Latch, Curved		H3187-1	(A)(1D)
R 02-010A	H3187-11	4	..Latch, Curved		H3187-9	(A)(1D)

C. Instructions/Dispositions Code Statements:

(A) New part is available.

(1D) Old part number can be reworked to new part number as instructed in this Service Bulletin.

D. Materials required to incorporate this Service Bulletin:

(1) Refer to the table that follows:

COMAT NO.	DESIGNATION
01-076	Solvent
01-457	Solvent
02-178	Masking Tape
05-112	Emery paper grade 0 grit size 400
07-152	Paint MIL-P-21563 colour no. 38903 per FED-STD-595 fluorescent red/orange, and Clear Lacquer to MIL-P-21563. Supplied by Aerospheres (UK) Ltd Aerospace House 2A Tudor Road Harrow Middlesex HA3 5PE England Tel.: 44-(0)181-863-8578 Fax.: 44-(0)181-427-1005

NOTE: To identify consumable materials, refer to the Overhaul Processes and Consumable Index (PCI-V2500-1IA).

3. Accomplishment Instructions

A. Pre-requisite Instructions

- (1) Open the Fan Cowl Doors as instructed in the A319/A320/A321 Aircraft Maintenance Manual, Task 71-13-00-010-010.

B. Rework Instructions

- (1) Apply masking tape (CoMat 02-178) around the sides of the 4 latches and over the outer surface of the latch handle (refer to IAE Standard Practices/Procedures Manual).

- (2) Use Emery paper (CoMat 05-112) to make the latch surface (shaded area) rough.

WARNING: SOLVENT IS FLAMMABLE AND THE VAPOUR IS HARMFUL. USE IN A WELL-VENTILATED AREA. AVOID PROLONGED BREATHING OF VAPOURS OR PROLONGED OR REPEATED CONTACT WITH SKIN. HIGH CONCENTRATIONS MAY CAUSE IMPAIRED JUDGEMENT. PROTECTIVE GLOVES SHOULD BE WORN DURING USE. MAY CAUSE DERMATITIS BY REMOVING SKIN OILS. PRIOR TO USE OF THIS PRODUCT, READ THE "MATERIAL SAFETY DATA SHEET" AND FOLLOW ALL LISTED SAFETY AND HEALTH PRECAUTIONS.

- (3) Clean the Fan Cowl Door Latch handles (refer to IAE Standard Practices/Procedures Manual) with a clean lint-free cloth (CoMat 02-099) made moist with solvent (CoMat 01-076) or (CoMat 01-457), or an alternative suitable solvent. Clean again with a dry lint-free cloth before the solvent evaporates.

- (4) Position Latch handles at a suitable angle for rework of paint area as shown (Refer to Figure 1).

WARNING: THE RED/ORANGE PAINT IS CLASSIFIED AS A HAZARDOUS MATERIAL WHICH MAY CAUSE INJURY OR ILLNESS IF NOT PROPERLY USED. THIS PRODUCT SHOULD BE USED ONLY IN ACCORDANCE WITH THE MANUFACTURERS SPECIFIC SAFETY AND HEALTH RECOMMENDATIONS. PRIOR TO USE OF THIS PRODUCT, CAREFULLY READ THE APPLICABLE "MATERIAL DATA SHEET" AND FOLLOW ALL LISTED SAFETY AND HEALTH PRECAUTIONS.

NOTE: The paint process detailed below involves the application of three coats of red paint and the application of one coat of clear lacquer. The paint and the lacquer are ordered under the one CoMat number 07-152.

- (5) Apply paint (CoMat 07-152) to the latches as follows:

- (a) Apply paint with a brush to the latches (shaded area) as shown (Refer to Figure 1).

- (b) Leave paint for 0.5 hours until dry to the touch.

- (c) Apply two more coats of paint to the latches as described in the previous 2 steps.
- (d) Completely dry the paint with a heat lamp placed so as to maintain a latch temperature of 70° C plus/minus 2° C for 1 hour.
- (e) Alternatively, completely dry the paint at room temperature in accordance with manufacturers requirements.

WARNING: THIS LACQUER IS CLASSIFIED AS A HAZARDOUS MATERIAL WHICH MAY CAUSE INJURY OR ILLNESS IF NOT USED PROPERLY. THIS PRODUCT SHOULD BE USED ONLY IN ACCORDANCE WITH THE MANUFACTURERS SPECIFIC SAFETY AND HEALTH RECOMMENDATIONS. PRIOR TO USE OF THIS PRODUCT, CAREFULLY READ THE APPLICABLE "MATERIAL SAFETY DATA SHEET" AND FOLLOW ALL LISTED SAFETY AND HEALTH PRECAUTIONS.

- (6) Apply Lacquer (CoMat 07-152) to the Latch as follows:
 - (a) Apply lacquer with a brush to the latches (shaded area) as shown.
 - (b) Leave the lacquer for 0.5 hours.
 - (c) Completely dry the lacquer with a heat lamp placed so as to maintain a latch temperature of 70°C plus/minus 2°C for 1 hour.
 - (d) Alternatively, completely dry the lacquer at room temperature in accordance with manufacturers requirements.
- (7) Remove masking tape and other unwanted material from the Fan Cowl Doors and Latches.
- (8) Identify the Fan Cowl Door Latches to the new part number H3187-11. Use the vibro-etch method. Refer to the IAE V2500 Standard Practices/Processes Manual, Chapter 70-09-00.

C. Post-requisite Instructions

- (1) Close the Fan Cowl Doors as instructed in the A319/A320/A321 Aircraft Maintenance Manual, Task 71-13-00-410-010.

D. Recording Instructions

- (1) Write in the Aircraft Log Book, or other records and metal stamp, or electroetch on the Fan Cowl Door data plate that Service Bulletin V2500-NAC-71-0227 Revision 1 has been done. Refer to IAE V2500 Standard Practices Manual, Chapter 70-09-00.

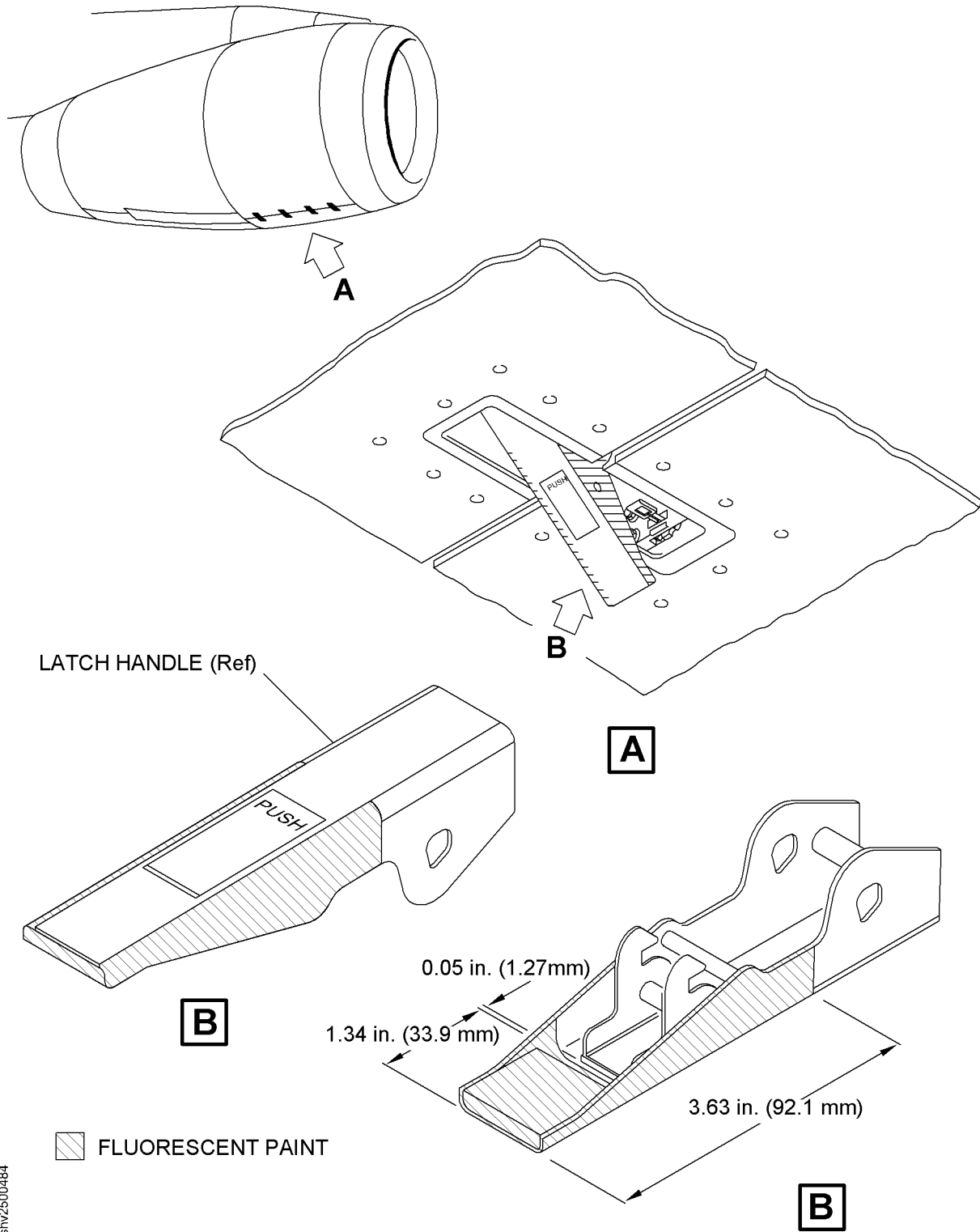

Painting of Fan Cowl Door Latch Handles
Figure 1