

**IAE Propulsion System  
NON-MODIFICATION  
SERVICE BULLETIN**

**NACELLE - POWERPLANT - THRUST STRUT ASSEMBLIES - EXAMINATION OF THE LOCKWIRE  
INSTALLATION  
(NON-MODIFICATION).**

**MODEL APPLICATION**

**V2500-D5**

**BULLETIN INDEX LOCATOR**

**71-00-00**

**Compliance Category Code**

**3**

**Internal Reference No.**

**JG 98VN539**

**December 3, 1998**

**V2500-NAC-71-0233**

**Page 1 of 5**

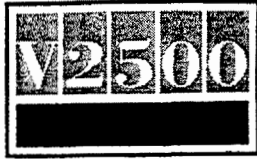

## IAE Propulsion System NON-MODIFICATION SERVICE BULLETIN

### NACELLE - POWERPLANT - THRUST STRUT ASSEMBLIES - EXAMINATION OF THE LOCKWIRE INSTALLATION (NON-MODIFICATION).

#### 1. Planning Information

##### A. Effectivity

###### (1) Aircraft

(a) Boeing DPD MD90

###### (2) Nacelle

(a) V2500-D5 engine build-up (EBU) serial numbers prior to 0418001.

##### B. Reason

The purpose of this Non Modification Service Bulletin is to examine the lockwire of the thrust struts for proper installation. The manufacturer has reported some thrust struts may have improperly installed lockwire.

##### C. Compliance

Category 3

Accomplish no later than the next "2-A" check.

##### D. Approval

Accomplishment of this Service Bulletin must be accomplished only in conjunction with Douglas Aircraft Company Service Bulletin MD-90-71-009 which has received exclusive FAA approval for the MD-90 Series Aircraft.

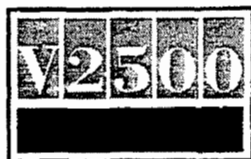

## IAE Propulsion System NON-MODIFICATION SERVICE BULLETIN

### E. Manpower

<u>VENUE</u>		<u>ESTIMATED MANHOURS</u>
(1)	In Service	
(a)	To gain access	0.5 M/Hrs.
(b)	To rework	1.5 M/Hrs.
(c)	To return to service	<u>0.5 M/Hrs.</u>
Total		2.5 M/Hrs.

### F. References

	<u>Chapter/Section</u>
MD90 Aircraft Maintenance Manual	71-12-11
IAE V2500 Standard Practices/Processes Manual (SPP-V2500-1IA)	70-42-05
Overhaul Processes and Consumable Index (PCI-V2500-1IA)	

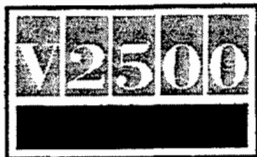

## IAE Propulsion System NON-MODIFICATION SERVICE BULLETIN

### G. Action

- (1) Open the upper and lower thrust reverser halves. Refer to the MD90 Maintenance Manual, Chapter 78-32-00, page block 201.
- (2) Examine the lockwire installation at both ends of the thrust struts. Refer to the IAE V2500 Standard Practices/Processes Manual (SPP-V2500-1IA), TASK 70-42-05-400-501, for proper lockwire installation procedures. Refer to Figure 1.
  - (a) If the lockwire installation is correct, go to step (4).
  - (b) If the lockwire installation is not correct, go to step (3).
- (3) Make the thrust strut lockwire installation correct.
  - (a) If you need to correct the lockwire installation at the forward end of the thrust strut, remove the core cowl panels for access. Refer to the MD90 Maintenance Manual, Chapter 71-12-11, page block 401.
  - (b) Remove the existing lockwire.
  - (c) Install the lockwire (CoMat 02-147) as instructed in TASK 70-42-05-400-501 of the IAE V2500 Standard Practices/Processes Manual (SPP-V2500-1IA).
  - (d) If removed, install the core cowl panels. Refer to the MD90 Maintenance Manual, Chapter 71-12-11, page block 401.
- (4) Close the upper and lower thrust reverser halves. Refer to the MD90 Maintenance Manual, Chapter 78-32-00, page block 201.

### H. Record of Accomplishment

A record of accomplishment is necessary.

### 2. Materials Required to Incorporate this Service Bulletin

Lockwire              CoMat 02-147

**NOTE:** To identify the consumable materials, refer to the Overhaul Processes and Consumable Index PCI-V2500-1IA.



IAE Propulsion System  
NON-MODIFICATION  
SERVICE BULLETIN

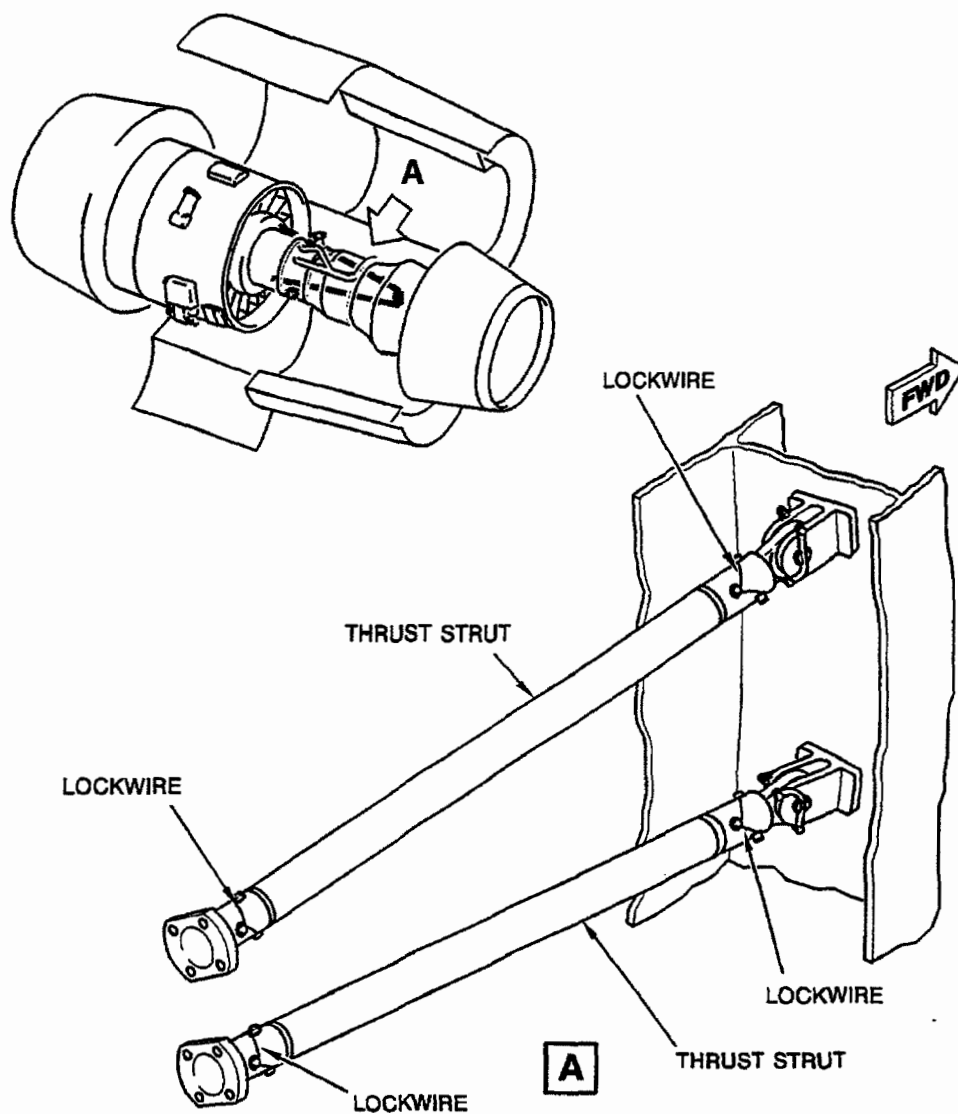

VSB665

Thrust Strut Lockwire Installation Examination  
Figure 1

December 3, 1998

**V2500-NAC-71-0233**

Page 5 of 5

