



NACELLE - EXHAUST - THRUST REVERSER, UNIQUE V2500-A5 CONFIGURATION - REIDENTIFICATION  
OF - CATEGORY CODE 6 - MOD.NAC-78-0095

1. Planning Information

A. Effectivity

- (1) Aircraft: (a) Airbus A320  
(b) Airbus A321
- (2) Nacelle: (a) V2500-A5 Thrust Reverser serial numbers 0421001  
thru 0428001 and 0433001 thru 0452001.

B. Reason

(1) Condition

V2500-A5 thrust reverser units contain cooling holes that are unique from V2500-A1 units.

(2) Background

V2500-A5 thrust reverser units require cooling holes for ventilation of rotated pressure regulating valve over the high pressure case.

(3) Objective

To provide unique part number for V2500-A5 thrust reverser units.

(4) Substantiation

Not applicable.

(5) Impact of Bulletin on Workshop Procedures:

Removal/Installation	Not affected
Disassembly/Assembly	Not affected
Cleaning	Not affected
Inspection/repair	Not affected
Repair	Not affected
Testing	Not affected

(6) Supplemental Information

None

V2500-NAC-78-0095



C. Description

The change introduced by this Bulletin reidentifies thrust reversers with additional cooling holes to V2500-A5 unique part numbers.

D. Approval

The part number changes and/or part modifications described in Paragraphs 2 and 3 of this Service Bulletin have been shown to comply with the applicable Federal Aviation Regulations and are FAA approved for the equipment model(s) listed.

E. Compliance

Category 6

Accomplish when the Nacelle subassembly (i.e. accessories, components) is disassembled sufficiently to afford access to the affected part and to all affected spare parts.

F. Manpower

Estimated Manhours to incorporate the full intent of this Bulletin:

VENUE	ESTIMATED MANHOURS
(1) In Service	Not applicable
(2) In Shop	
(a) To Embody	0.5 M/Hrs.

G. Material Cost and Availability

None required.

H. Tooling Cost and Availability

None required.

I. Weight and Balance

- (1) Weight change . . . . . None
- (2) Moment arm. . . . . No effect
- (3) Datum. . . . . Engine Front Mount Centerline
- . . . . . (Power Plant Station PPS 100.00)



J. Electrical Load Data

Not affected.

K. References

(1) Internal Reference No.

94VN036A/B

(2) Other References

Overhaul Processes/Consumable Index  
(PCI-V2500-1IA)

IAE V2500 Standard Practices/Processes 70-09-00  
Manual (SPP-V2500-1IA)

IAE V2500 Service Bulletin:  
V2500-NAC-78-0087-Nacelle-Exhaust-Vent  
Holes, Left Thrust Reverser Door-  
Modification and Addition of

L. Other Publications Affected

A320/V2500-A5 Engine Illustrated 78-30-00  
Parts Catalog (S-V2500-2IA)

A320/A321/V2500A5 Power Plant 78-30-00  
Illustrated Parts Catalog  
(PIP-V2500-2IA)



2. Accomplishment Instructions

A. Prerequisite Instructions

None.

B. Rework or Modification Instructions – Thrust Reverser Left Half

- (1) Find inner barrel area on 740-0002-713 or -715 left thrust reverser door.
- (2) Make sure the thrust reverser door and 740-0220-297 forward heatshield have two additional vent holes. Refer to Figure 1. If additional vent holes are not in thrust reverser doors and forward heatshield, refer to IAE Service Bulletin V2500-NAC-78-0087.
- (3) Reidentify 740-0220-297 forward heatshield to 745-0220-1 with rubber stamp and black ink (CoMat 06-073). Refer to IAE V2500 Standard Practices/processes Manual, Chapter 70-09-00.

C. Post requisite Instructions

None.

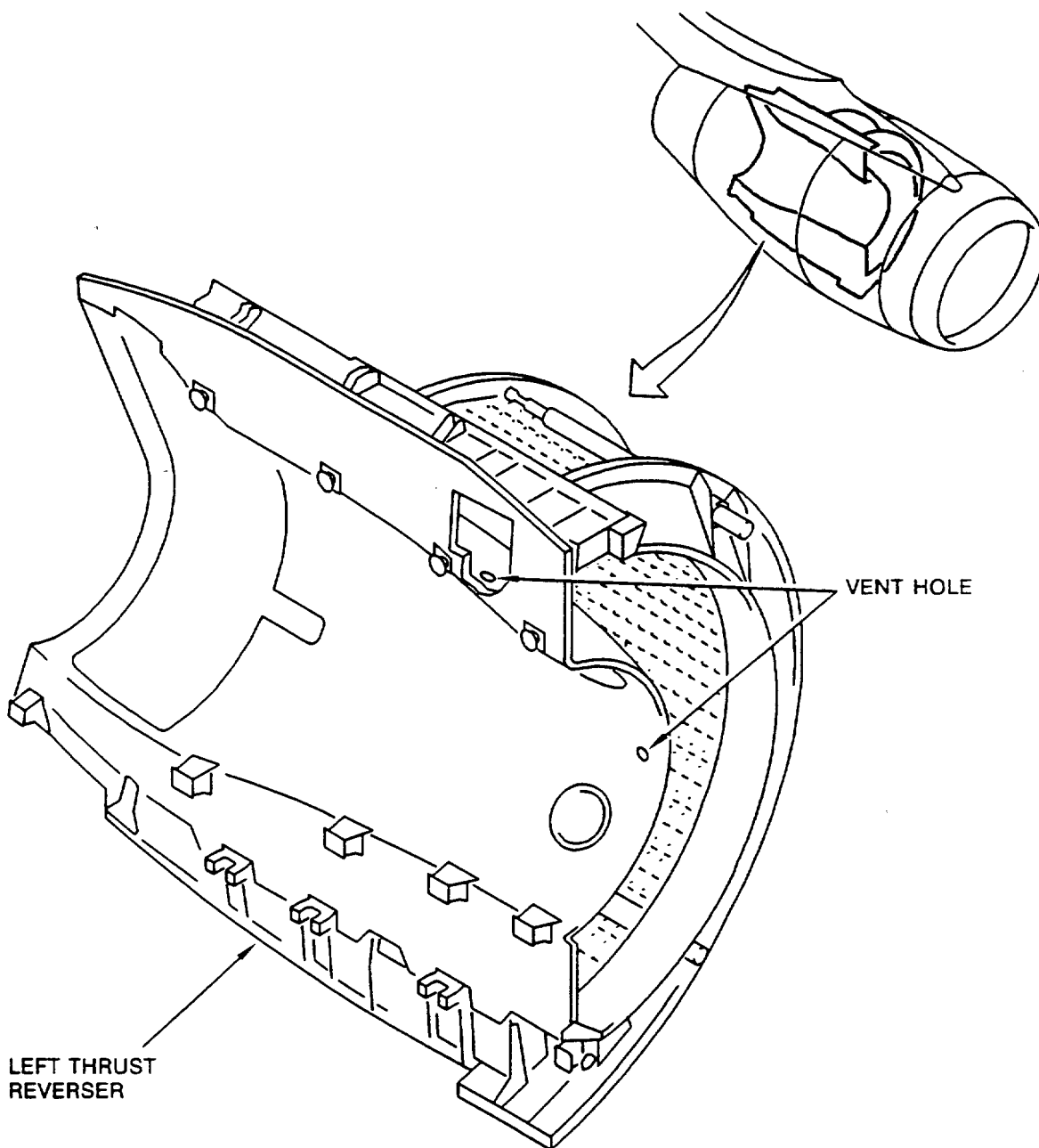

ded0001354

Left Half Thrust Reverser with Two (2) Vent Holes  
Fig.1

V2500-NAC-78-0095



**D. Recording Instructions**

- (1) Find nameplate on forward lower area of left thrust reverser door. Refer to Figure 2.
- (2) Make a mark through 740-0002-713 or -715 part number on nameplate.
- (3) Add "S/B 78-0095 RWK to 745-0002-501" to nameplate for 740-0002-713 and "S/B 78-0095 RWK TO 745-0002-505" for 740-0002-715 with metal stamp, electroetch, or vibroetch method. Refer to IAE V2500 Standard Practices Manual, Chapter 70-09-00.

**NOTE:** Right thrust reverser doors 740-0002-705 and -707 are interchangeable with 745-0002-503 and -507 right thrust reverser doors. Production doors will be numbered with "745 prefix" type part number to help identify the difference between V2500-A1 and -A5 doors. See Section 3. Material Information for applicable part numbers.

**V2500-NAC-78-0095**



## SERVICE BULLETIN

Printed in Great Britain

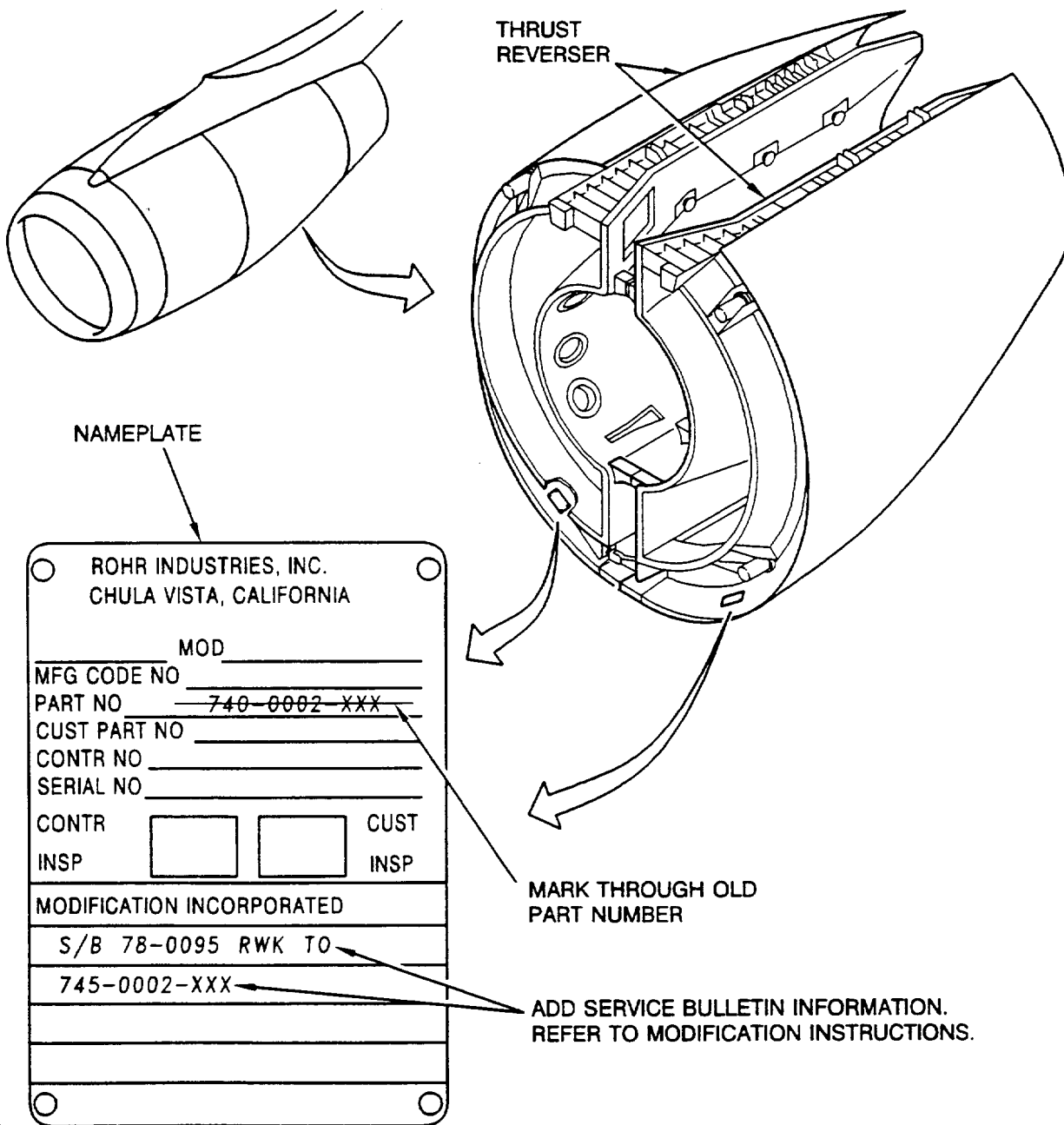

ded0001355

Nameplate  
Fig.2

V2500-NAC-78-0095



## SERVICE BULLETIN

3. Material Information

Applicability: For each V2500-A5 Nacelle to incorporate this Bulletin.

A. Kits associated with this Bulletin:

None required.

B. Parts affected by this Bulletin:

NEW PART NO. (ATA NO.)	QTY	EST'D UNIT PRICE (\$)	KEYWORD	OLD PART NO. (IPC NO.)	INSTR/ DISPOS
745-0002-501 (78-30-00)	1	RQ	No. 1 LH T/R	740-0002-713 (01-130)	(1D)
745-0002-505 (78-30-00)	1	RQ	No. 2 LH T/R	740-0002-715 (02-130)	(1D)
745-0002-503 (78-30-00)	1	RQ	No. 1 RH T/R	740-0002-705 (01-140)	(S1)
745-0002-507 (78-30-00)	1	RQ	No. 2 RH T/R	740-0002-707 (02-140)	(S1)
745-0220-1 (78-32-49)	1	RQ	Heatshield	740-0220-297 (30-230)	(1D)

C. Instructions/Disposition Code Statements:

(S1) Old part is an alternate to new part number.

(1D) New part number may be obtained by rework and reidentification.

D. Materials Required to Incorporate This Service Bulletin:

CoMat 06-073                      Black Ink

NOTE: To identify the consumable materials, refer to the  
Overhaul Processes and Consumable Index PCI-V2500-1IA.

V2500-NAC-78-0095